

SNOWFLOW BLADES

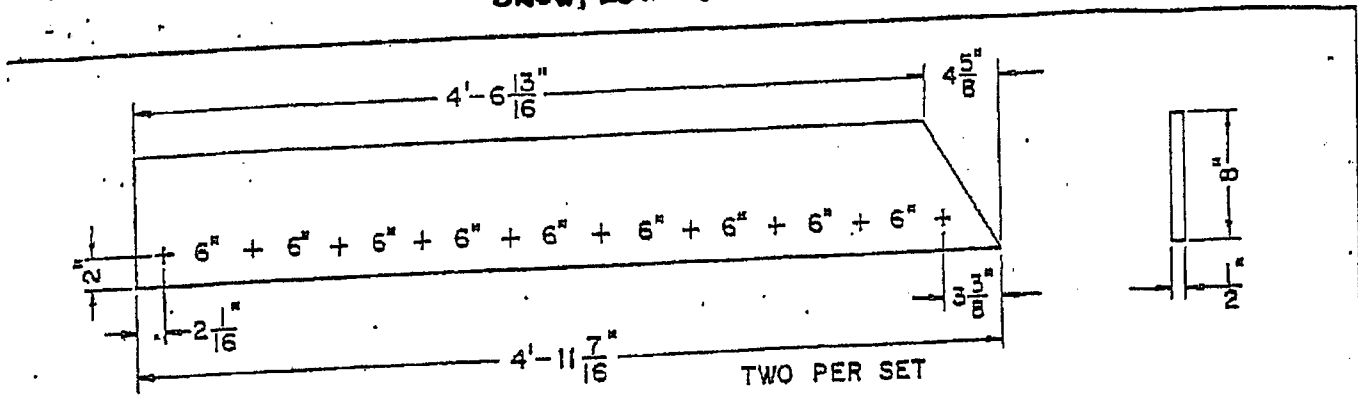

CODE NO. 118

FLINK MODEL 265A "V" PLOW

10 HOLES

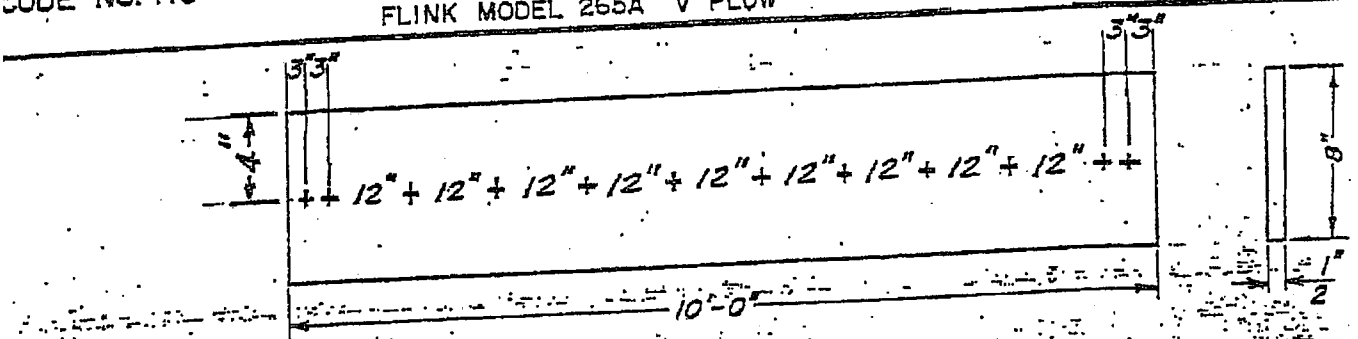

CODE NO. 119

12 Holes $11\frac{1}{16}"$ sq.

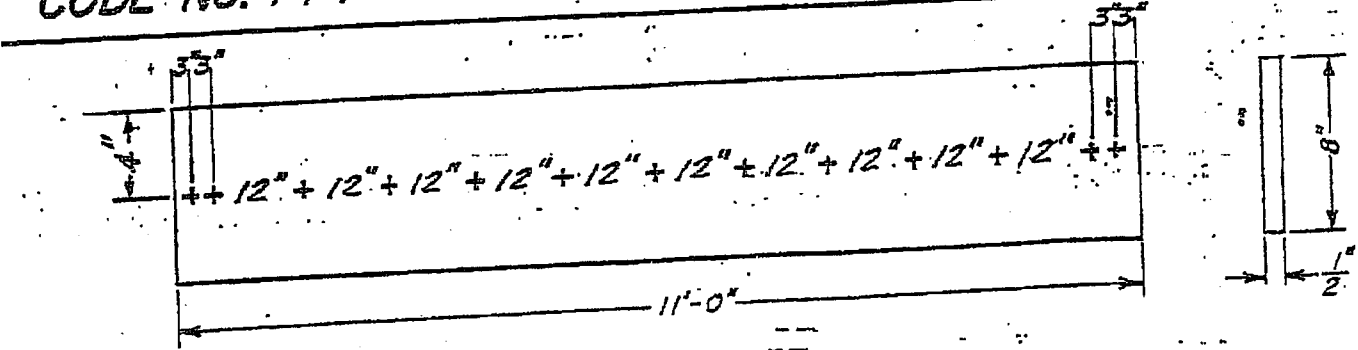

CODE NO. 120

13 Holes $11\frac{1}{16}"$ sq.

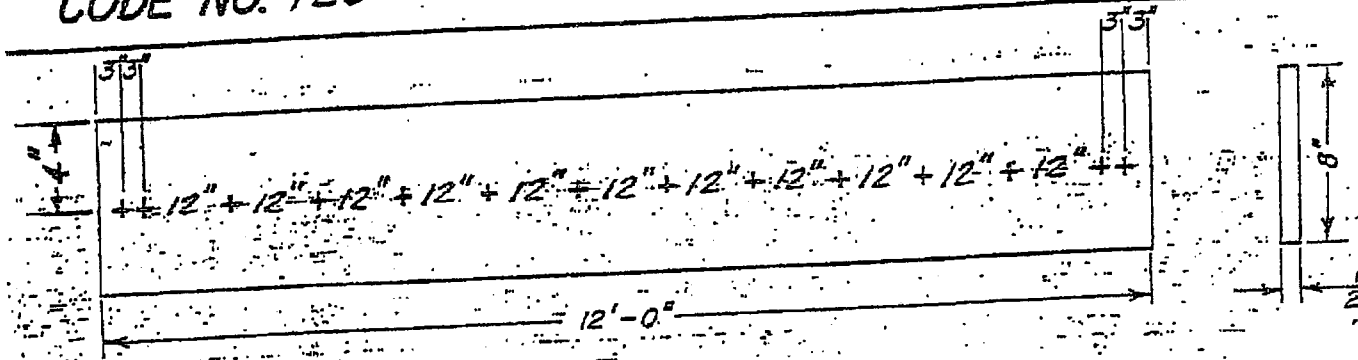

CODE NO. 121

14 Holes $11\frac{1}{16}"$ sq.

MID-MOUNT WINGPLOW DIAGRAM

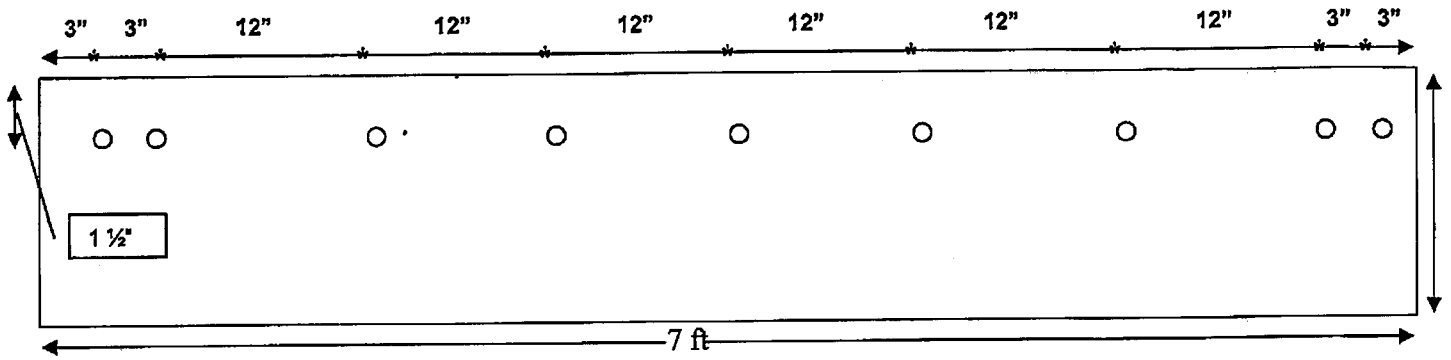

Commodity Code # 3531-613-1082

Part #05031074

Snowplow Cutting Edge for Mid Mount Wingplow

11/16" Square Punch Holes (Not Center Punch)

03/2011

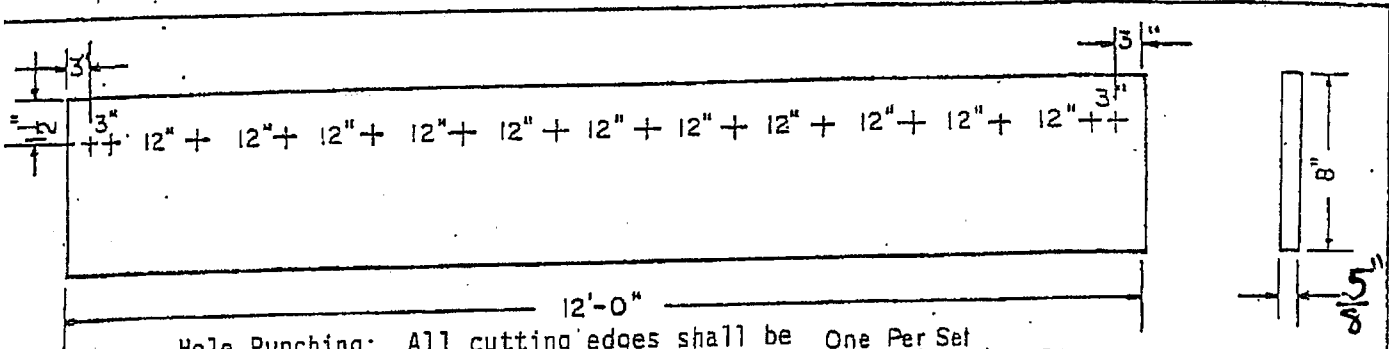

Hole Punching: All cutting edges shall be One Per Set punched to accept #3 countersunk head, squareneck (plow) bolts. 14 Holes

CODE NO. 94

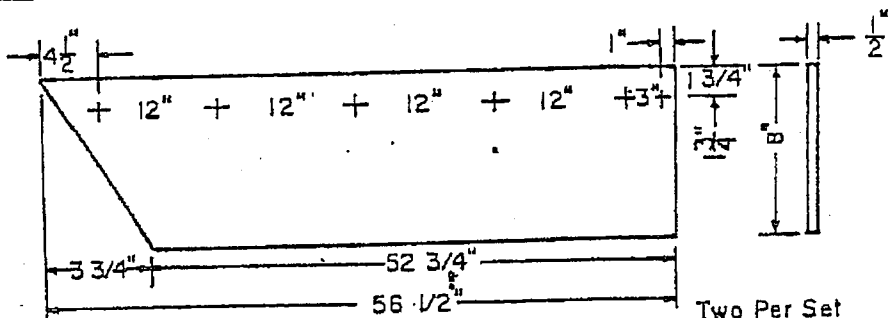

Two Per Set 6 Holes

CODE NO. 97

Gledhill Model 482.5 "V" Plow, Gledhill Plow-Model 488-5V2 "V" Plow

Hole Punching: All cutting edges shall be punched to accept #3 countersunk head, squareneck (plow) bolts.

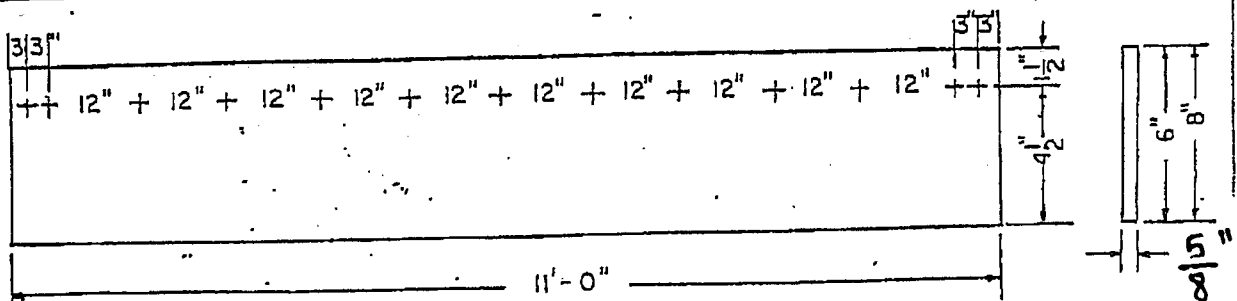

Hole Punching: All cutting edges shall be One Per Set punched to accept #3 countersunk head, squareneck (plow) bolts. 13 Holes

CODE NO. 98